

LIST PRICING

JANUARY 1, 2021

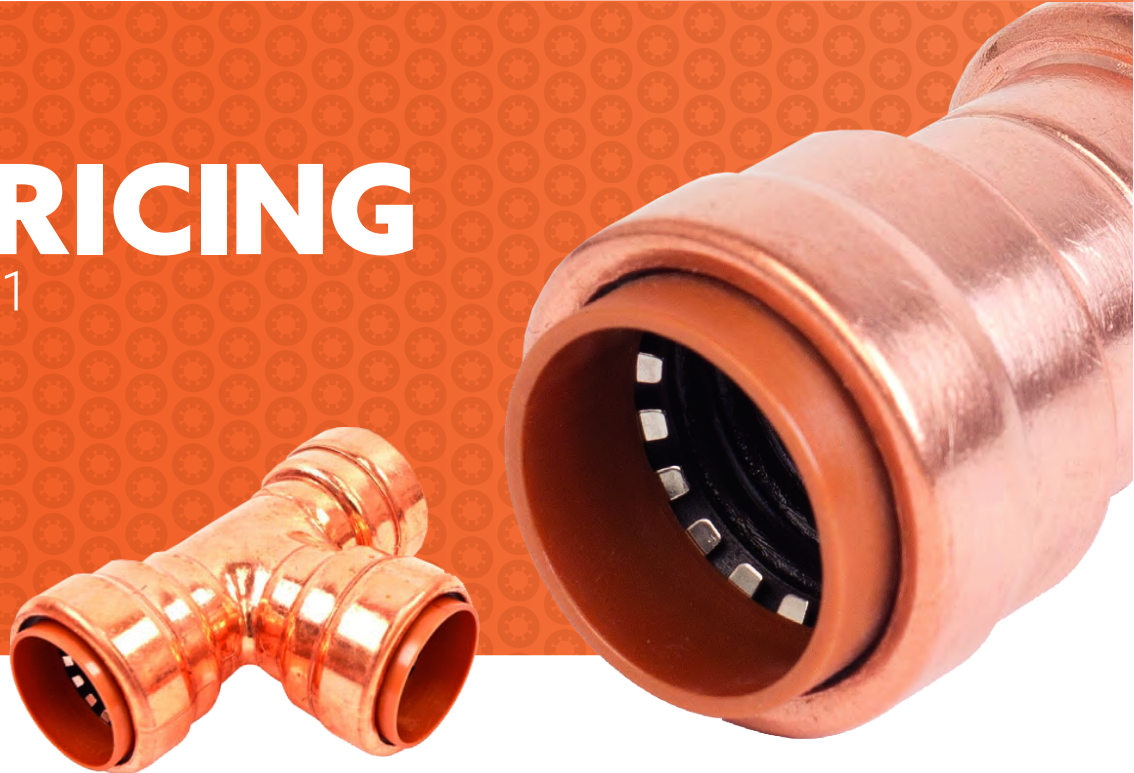

COPPERHEAD

BY  QUICKFITTING®

EASY - DURABLE - RELIABLE

COPPERHEAD® PUSH FITTINGS

Pricing effective as of January 1, 2021, is subject to change without notice. This pricing revision replaces all previously stated pricing communications.

U.S. Patent #8,205,915

Note: Given the current market volatility of commodity metals such as copper, check with the factory before providing contract or extended term pricing to OEMs or resellers.

Quick Fitting Holding Company, LLC.
655 Waterman Ave., East Providence, RI, USA 02914
Tel: (877) 238-4826 / Fax: (877) 258-4826





ABOUT US

Quick Fitting Holding Co. is an innovative U.S. inventor, manufacturer and supplier of quick connection technology that provides a simpler, safer, and a more cost-effective solution for connecting copper, PEX and CPVC piping in plumbing and heating applications. No open flames or sealants needed, just quickly clean the end of the pipe and snap the fitting into place; a proven method used by professional contractors and advanced do-it-yourselfers alike.

Located in Warwick, Rhode Island, Quick Fitting has become a leading innovator in push-to-connect technology with more than 100 patents to its credit.

Our products are a great labor-saving tool. Our simple push fit technology makes it easy for plumbing professionals and the advanced do-it-yourselfers as well, saving the installer 70 - 90% of the installation time over conventional soldering or welding methods. For plumbing professionals, the increased speed offers the ability to complete more jobs in less time, increasing the number of daily service calls and their profitability. In addition, our fittings are designed and warranted to last longer than any other conventional method, up to 75 years.

We manufacture a broad selection of innovative push to connect products with a compelling competitive value proposition. In addition to our strengths as a high-quality, world-class manufacturing company, Quick Fitting has consistently developed and delivered on new product innovations. Innovation is in everything we do at Quick Fitting. Perhaps that's one reason Quick Fitting has been honored twice by receiving the prestigious Plant Engineering "Product of the Year Award" for our innovations in push connect plumbing technology.



COPPERHEAD

BY QUICKFITTING

**BEST IN CLASS
PATENTED TECHNOLOGY
SUPERIOR PERFORMANCE
ADVANCED DESIGN
NO HARMFUL CHEMICALS**



AVAILABLE SIZES: 1/2", 3/4", 1"

FEATURES	BENEFITS	APPLICATIONS
All Applicable Approvals	Fast Connection	Plumbing
Patented Design	Instant Connect	Marine
Lead-Free Copper	Lead Law Compliant	Irrigation
Removable & Reusable	No Dezincification	RV & Mobile Homes
Installs Wet or Dry	No Glues or Soldering	Heating
Zinc-Free	75 Year Warranty	Outdoor Plumbing

TESTING & APPROVALS: cUPC, ASSE1061, ANSI/NSF 61 AND NSF 372, DEZINCIFICATION RESISTANT (NO ZINC CONTENT), CERTIFIED CLORIMIDE RESISTANT SEALS, LEAD LAW COMPLIANT.

KEY ADVANTAGES: Superior thermal properties, excellent chemical resistance, solid copper body, recognized brand, value priced. All CopperHead® copper products are 100% dezincification resistant.

CopperHead® 99.97% copper push fittings contain no lead or zinc and no arsenic additives, making it naturally lead law compliant and not subject to dezincification. Copper is well known for its strength and superior heat transfer properties in plumbing applications. Copper is also recognized as a premium material of construction by plumbing professionals. In a recent blind study, 8 out of 10 professional plumbers selected our copper push fit technology when presented with a choice of plastic, brass or copper.

CopperHead® is the clear alternative to any competitive product in the market today.

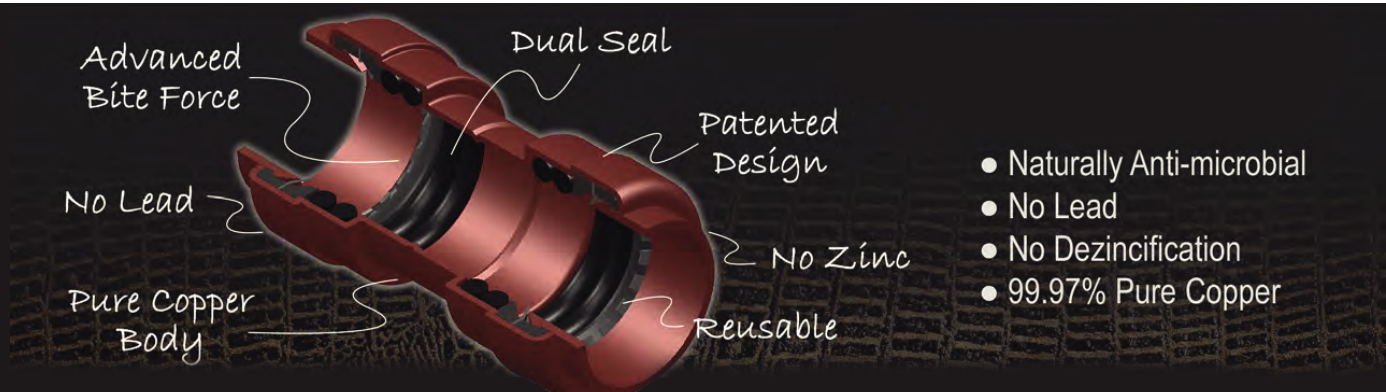

COPPERHEAD

BY QUICKFITTING

COPPERHEAD® LEAD LAW COMPLIANT PRODUCTS

As we learned years ago with paint, lead can be very dangerous to humans. This danger brought about laws that prohibited the use of lead-based paints, and now, there is a lead law that lowers the acceptable Pb (lead) levels in all brass products used in potable water systems. Potable water systems are water systems used for both cooking and consumption.

In 2006, California passed the AB1953 Lead Law, now NSF 372, which went into effect on January 1, 2010. The law mandates lead levels on products used in a potable water system to contain less than 0.25% lead. In January 2011, the U.S. Safe Drinking Water Act was signed into law. The law took effect nationwide on January 4, 2014. As of 2014, all plumbing fittings used in water systems for cooking and potable water must be lead-free (less than 0.25% lead).

CopperHead® makes complying with the lead law very easy by providing lead law-compliant no-lead copper fittings.

In addition to our lead law-compliant copper, CopperHead® fittings and valves are tested to be zinc-free and dezincification resistant. The high-performance seals used in our push fit products are certified Chloramine resistant.

Installation of our push fittings takes just a few seconds, and it is easy for professionals, as well as those who are completing do-it-yourself projects. Get lead out of your life and your drinking water with CopperHead® fittings.



Installation Tips

Installation - Cut, clean, mark the tube, push to connect... you're done!

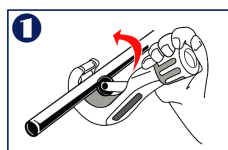

1. Cut the pipe or tubing

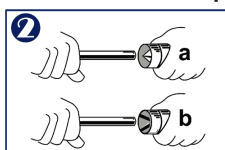

2. (2a) Ream, then de-burr (2b)

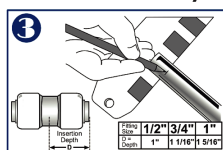

3. Mark the insertion depth

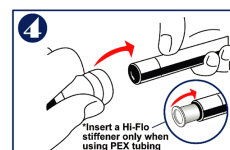

4. Insert the pipe or tubing.

Removal & Reuse



Removal - Attach the removal clip & depress the grip ring to remove.

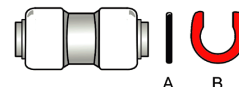
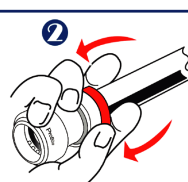
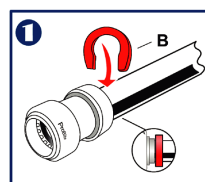

A. Replaceable sealing ring
B. Removal clip

Sealing O-rings (A) are easily removed and replaced (U.S. & Foreign Patents Pending).

Note: A Quick Fitting Hi-Flo tube stiffener should be used on PEX pipe.

COPPERHEAD

BY QUICKFITTING





COPPERHEAD® PUSH-TO-CONNECT



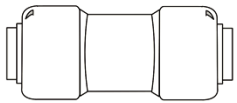

Copper - No Lead, No Zinc or Harmful Metals





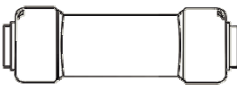





No Harmful Chemicals

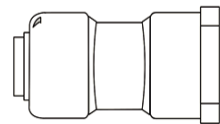

Couplings	Part #	Description		Bag Qty	Box Qty	List Price	
	CH-HF811	1/2" x 1/2" Straight Coupling		1	30	\$11.80	C
	CH-HF821	3/4" x 3/4" Straight Coupling		1	25	\$10.43	C
	CH-HF831	1" x 1" Straight Coupling		1	15	\$19.17	C

Slip Couplings	Part #	Description		Bag Qty	Box Qty	List Price	
	CH-HF817	1/2" Slip Coupling, removal clip		1	15	\$15.16	C
	CH-HF827	3/4" Slip Coupling, removal clip		1	15	\$19.45	C
	CH-HF837	1" Slip Coupling, removal clip		1	10	\$40.84	C

Reducing Couplings	Part #	Description		Bag Qty	Box Qty	List Price	
	CH-HF841	3/4" x 1/2" Reducing Coupling		1	25	\$15.23	C
	CH-HF8413	1" x 3/4" Reducing Coupling		1	20	\$20.49	C

Female Adapters	Part #	Description		Bag Qty	Box Qty	List Price	
	CH-HF812F	1/2" x 1/2" FNPT Female Adapter		1	30	\$10.33	C
	CH-HF842F	1/2" x 3/4" FNPT Female Adapter		1	25	\$12.36	C
	CH-HF8322F	1" x 3/4" FNPT Female Adapter		1	15	\$21.66	C
	CH-HF822F	3/4" x 3/4" FNPT Female Adapter		1	25	\$12.20	C
	CH-HF832F	1" x 1" FNPT Female Adapter		1	15	\$20.94	C



NO GLUE



NO FLAMES







**NO GLUE, NO FLAMES...
INSTALL FASTER AND MOVE
ON TO THE NEXT JOB**



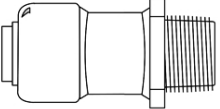







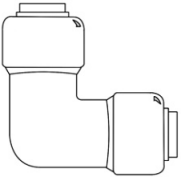





COPPERHEAD® PUSH-TO-CONNECT

Copper - No Lead, No Zinc or Harmful Metals 

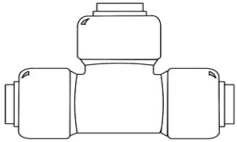
No Harmful Chemicals 

Male Adapters	Part #	Description		Bag Qty	Box Qty	List Price	
	CH-HF821M	1/2" x 1/2" MNPT Male Adapter		1	30	\$9.12	C
	CH-HF842M	1/2" x 3/4" MNPT Male Adapter		1	25	\$12.37	C
	CH-HF822M	3/4" x 3/4" MNPT Male Adapter		1	25	\$12.31	C
	CH-HF8322M	1" x 3/4" MNPT Male Adapter		1	20	\$23.86	C
	CH-HF832M	1" x 1" MNPT Male Adapter		1	20	\$22.02	C

Elbows	Part #	Description		Bag Qty	Box Qty	List Price	
	CH-HF813	1/2" x 1/2" Elbow		1	30	\$10.99	C
	CH-HF843	3/4" x 1/2" Reducing Elbow		1	25	\$14.13	C
	CH-HF813F	1/2" x 1/2" FNPT Elbow		1	30	\$13.90	C
	CH-HF813M	1/2" x 1/2" MNPT Elbow		1	30	\$14.10	C
	CH-HF823	3/4" x 3/4" Elbow		1	25	\$15.99	C
	CH-HF8343	1" x 3/4" Reducing Elbow		1	15	\$29.99	C
	CH-HF833	1" x 1" Elbow		1	15	\$26.65	C

Tees	Part #	Description		Bag Qty	Box Qty	List Price	
	CH-HF814	1/2" x 1/2" x 1/2" Tee		1	20	\$14.62	C
	CH-HF825	3/4" x 1/2" x 3/4" Reducing Tee		1	15	\$21.33	C
	CH-HF815	3/4" x 1/2" x 1/2" Reducing Tee		1	15	\$19.10	C
	CH-HF844	3/4" x 3/4" x 1/2" Reducing Tee		1	15	\$20.43	C
	CH-HF824	3/4" x 3/4" x 3/4" Tee		1	15	\$20.95	C
	CH-HF834	1" x 1" x 1" Tee		1	10	\$38.83	C

COPPERHEAD

BY QUICKFITTING





COPPERHEAD® PUSH-TO-CONNECT



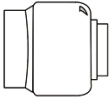

Copper - No Lead, No Zinc or Harmful Metals



No Harmful Chemicals



End Stops	Part #	Description		Bag Qty	Box Qty	List Price	
	CH-HF816	1/2" End Stop		1	40	\$9.13	C
	CH-HF826	3/4" End Cap		1	30	\$10.51	C
	CH-HF836	1" End Cap		1	20	\$20.47	C

45 Degree Elbows	Part #	Description		Bag Qty	Box Qty	List Price	
	CH-HF8134	1/2" x 1/2" 45° Elbow		1	30	\$12.89	C
	CH-HF8234	3/4" x 3/4" 45° Elbow		1	25	\$17.35	C
	CH-HF8334	1" x 1" 45° Elbow		1	15	\$31.63	C

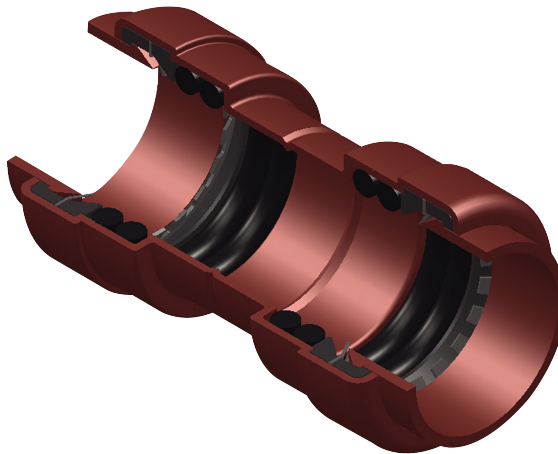

NO GLUE



NO FLAMES

**NO GLUE, NO FLAMES...
INSTALL FASTER AND MOVE
ON TO THE NEXT JOB**

COPPERHEAD

BY QUICKFITTING

FREQUENTLY ASKED QUESTIONS

Joining Copper, PEX or CPVC Tubing

Q: Do I need to prepare the tube ends differently when using push fittings?

A: No, as with sweat copper fittings, the tube must be chamfered, de-burred and reamed (free from burrs and debris). Quick Fitting recommends the use of an Inner/Outer Reamer to chamfer, de-burr and ream tube ends. These steps are essential to ensure the proper connection of your CopperHead® push-to-connect fitting. Also, be sure to draw an insertion mark on the tube to indicate the proper insertion of the tubing into the fitting.

Q: What types of tubing can be used with CopperHead® fittings?

A: CopperHead® connectors are approved for use with Copper, CPVC and PEX.

Q: Should I use a tubing insert stiffener on Copper, PEX and CPVC?

A: A stiffener is only required when connecting PEX tubing.

Q: Should I pressure test my system following the installation of push fittings?

A: Yes, as with all types of plumbing fittings, new installations should be pressure tested to ensure a proper connection.

Q: Can I install push fittings in a wet (charged) system?

A: Push fittings can be installed wet or dry. System pressures should be relieved to avoid injury prior to installation.



Installing, Testing and Flushing Your Push Fit System

Q: Can a CopperHead® fitting blow off a water system?

A: NO, the grip ring technology utilizes an opposing force principle, which simply put, the higher the force used to pull the fitting, the deeper the fitting bites into the tubing.

Q: What have CopperHead® fittings been tested to at the factory?

A: CopperHead® fittings are factory tensile tested to over 900 pound force and temperatures of 200 °F.

Q: What support hanger spacing must I use with my CopperHead® System?

A: Support requirements are identical to a sweat system; as such installers should adhere to local codes. Always fully support heavy loads on your plumbing system.

Q: How do I test my CopperHead® System?

A: Pressure testing should be conducted the same way as you would with a Copper sweat system. The system should be installed, pressurized and then held under pressure for a period determined by your local plumbing regulations.

Q: Do I need to lubricate the fitting when installing?

A: No, CopperHead® seals are factory-lubricated with an NSF-61 approved lubricant.

Q: Do I still have to flush my system?

A: Yes, but the system will be cleaner and flush faster since there is no solder or flux.

Q: Should I use glue or solder when installing CopperHead?

A: Glues, adhesives or sealants are not required and should never be applied to the connection, fitting or tubing.



SPECIFICATION FOR PUSH FIT COPPER FITTING SYSTEM

System

1.1 The fittings and valves shall be of the push to connect type (Manufacturer - Quick Fitting Holding Company) and shall be manufactured to the quality system of ISO 9001 and be NSF/ANSI/CAN 61-2020 certified.

1.2 The system shall be full bore passage without diameter restriction for the fittings, in order to avoid high pressure drop.

Pipe

2.1 Copper pipe shall conform to ASTM B-88 and may be type K, L, or M seamless copper.

2.2 CPVC pipe shall conform to ASTM D2846, CSAB137.6.

2.3 PEX tubing shall conform to ASTM F-876, CSA B137.5. Tube support liners provided by Quick Fitting Inc, shall be used.

2.4 Plumbing systems must be installed in compliance with local plumbing code.

Fittings & Valves

3.1 Fittings and valves shall be NSF 61/NSF 372 certified; and have a maximum operating pressure of 200 PSI at a maximum continuous operating temperature of 200°F. Higher temperatures and pressures may be permissible; please consult with manufacturer.

3.2 Fittings shall utilize copper alloy bodies meeting ASTM B-283 standard with stainless steel gripping teeth and shall use EPDM seals that are certified to NSF-61 service.

3.3 Fittings and valves shall incorporate a one-step connection method: push-to-connect, no prelubrication required.

3.4 Fittings and valves shall permit 360° rotation of the pipe while system is depressurized.

3.5 Fittings and valves shall be removable and reusable with the use of a removal tool (Manufacturer - Quick Fitting Holding Company.)

3.6 Fittings shall use NSF-61 approved pre-lubricated EPDM seals so that additional lubrication or fitting preparation is not needed.

3.7 Fittings shall be design certified to ASSE-1061, NSF/ANSI/CAN 61-2020, and NSF/ANSI/CAN 372-2020 standards.

System Installation

4.1 Fittings shall be installed according to Quick Fitting installation instructions.

4.2 Pipe ends shall be chamfered, de-burred, reamed, and depth marked prior to fitting or valve installation. When cutting tubing, ensure that the ends are cut square and are free of burrs.

4.3 Ensure that there are no scratches, gouges or any form of damage on the circumference of the tube within the specified depth on Table 1.1. Damage in this area may cause leakage. Check the fitting for any signs of damage or foreign objects. Push the CopperHead® fitting onto the end of the copper pipe until depth mark is covered.

Insertion Depth Table 1.1

Fitting Size	1/4"	3/8"	1/2"	3/4"	1"	1 1/4"	1 1/2"	2"
Depth	1/2"	13/16"	1"	1 1/16"	1 5/16"	1 11/16"	1 5/8"	1 3/4"

4.4 Use only in accordance with Quick Fitting's specifications and operating instructions. NOTE: Drinking water supplies that are less than pH 6.5 may require corrosion control to limit leaching of copper into the drinking water.

4.5 If PEX tubing is used, then a tube support liner must be used also. The tube support liner acts as an internal support for the end of the tubing.

4.6 When a joint has to be disassembled and then reused, ensure that the tubing removed from the joint has no damage on the circumference within the specified depth on Table 1.1. Inspect the tube and connection for any signs of damage and ensure they are free of foreign materials. The joint can then be reassembled.

4.7 Installations should be pressure tested to ensure proper insertion of the push fittings.



TERMS AND CONDITIONS

RETAIL PACKAGING

Quick Fitting UPC bar-coded retail and private label packaging is available. Contact your Quick Fitting representative for more information.

MINIMUM ORDER SIZE

Minimum net order value is \$75.00.

FREIGHT POLICY

Unless otherwise indicated, products are shipped using carriers that will represent the best "Shipping Value" for our customers. Shipping Value is determined by the quality of performance and further measured by the pricing. Orders in excess of \$1,500 will ship by Quick Fitting's carrier of choice full freight allowed (FFA) to the contiguous United States.

QUICK FITTING™ PRODUCT RETURN POLICY

Purchasers wanting to return items for credit may do so under the following conditions:

1. All returns require a Return Goods Authorization (RGA) number, which is active for 30 days from the date of issue. Contact Quick Fitting's Customer Service RGA assistance. Returned items must have the RGA# clearly visible on the outside of the package, along with any related documents or they cannot be accepted.
2. All inventory returns for credit must be received no later than the ninth month of the calendar year and the credit will be issued only to the original purchaser.
3. Private label and soft private branded products are not returnable for credit.
4. A 25% restocking charge will apply to all returns.
5. All returned items must be returned in their original packaging. Returned items must be complete with all manuals, documentation, etc. Acceptable returns must be in their original packaging, unused, free from defects or scarring and be current, non-obsolete product.
6. Returns must be made within 180 days of the date indicated on the original Purchase Order.
7. Custom items may not be returned for credit.
8. Products must be shipped back to Quick Fitting freight prepaid. Quick Fitting will not be responsible for any freight charges, duties, or fees and no credit will be given for them. Returns should be addressed to Quick Fitting Holding Co. Attn: Return Goods, 30 Plan Way, Warwick, RI02886.
9. Returns not meeting the above terms and conditions will be rejected and either returned to sender or disposed of at the senders written direction.
10. Quick Fitting will not be responsible for inventory returns that are lost or damaged during the transportation to our facility. The original shipper should insure all returns to the full value of the return.

PAYMENT TERMS

All invoices are payable and due, unless credit terms have been established.

**75-YEAR COPPERHEAD® FITTING WARRANTY**

Supplier warrants its CopperHead® push fit fittings to be free of defects in material and workmanship in water service and other approved materials, for a period of seventy-five (75) years from the date of purchase of the products. Supplier makes no other warranties, express or implied. This limitation explicitly excludes any implied warranty of merchantability or fitness for a particular purpose. The sole remedy for breach of this warranty of material and workmanship or for negligence in manufacture or design is limited to replacement or repair of the fitting, at the sole option of Supplier, of any defective parts which are returned to Supplier (prepaid) within seventy-five (75) years of original purchase. CopperHead® fittings contain a replaceable O-ring seal, which is warranted for replacement in water service for a period of (75) seventy-five years. In no event shall Supplier be liable for indirect, special, incidental or consequential damages of any kind. No allowance will be made for repairs made by the purchaser.

COPPERHEAD® VALVE & CONTROL WARRANTY

Supplier warrants its CopperHead® push fit ball valves, stop valves and controls to be free of defects in material and workmanship in water service and other approved materials, for a period of seven (7) years from the date of purchase of the products. Supplier makes no other warranties, express or implied. This limitation explicitly excludes any implied warranty of merchantability or fitness for a particular purpose. The sole remedy for breach of this warranty of material and workmanship or for negligence in manufacture or design is limited to replacement or repair of the fitting, at the sole option of Supplier, of any defective parts which are returned to Supplier (prepaid) within seven (7) years of original purchase. In no event shall Supplier be liable for indirect, special, incidental or consequential damages of any kind. No allowance will be made for repairs made by the purchaser.

COPPERHEAD® SUPPLY LINE WARRANTY

Supplier warrants its CopperHead® push fit supply line connectors to be free of defects in material and workmanship in water service and other approved materials, for a period of five (5) years from the date of purchase of the products. Supplier makes no other warranties, express or implied. This limitation explicitly excludes any implied warranty of merchantability or fitness for a particular purpose. The sole remedy for breach of this warranty of material and workmanship or for negligence in manufacture or design is limited to replacement or repair of the fitting, at the sole option of Supplier, of any defective parts which are returned to Supplier (prepaid) within five (5) years of original purchase. In no event shall Supplier be liable for indirect, special, incidental or consequential damages of any kind. No allowance will be made for repairs made by the purchaser.

THIS WARRANTY IS EXPRESSLY IN LIEU OF ANY AND ALL OTHER WARRANTIES AND REPRESENTATIONS, EXPRESS OR IMPLIED, INCLUDING BUT NOT LIMITED TO, THE WARRANTY OF FITNESS FOR A PARTICULAR PURPOSE AND THE WARRANTY OF MERCHANTABILITY. THERE ARE NO WARRANTIES, WHICH EXTEND BEYOND THE DESCRIPTION ON THE FACE HEREOF. THE EXCLUSIVE REMEDY FOR DEFECTIVE PRODUCTS SHALL BE ONLY AS STATED HEREIN.



Supplier does not warrant the design, assembly or installation of any system using COPPERHEAD®, but only the components as stated herein. Supplier is not responsible for improper design, assembly or installation, or for any modifications of the Supplier products.

THE WARRANTY HEREIN IS VOID UPON:

- a) Failure to follow any of the assembly or installation guidelines;
- b) Alteration, misuse or abuse of, or damage to, any of the Supplier products;
- c) Operation beyond the design range, excessive pressure or stress, or mishandling in any way;
- d) Use other than for the intended purpose or in a manner other than as specified by Supplier;
- e) Improper assembly, installation, service or maintenance;
- f) Use on fluids that are abrasive, aggressive, acidic, pH less than 6.5 or containing metals or chemicals.

This Limited Warranty, and Supplier's responsibility, may be further limited, but may not be expanded by Supplier's terms and conditions of sale, as set forth on the front or reverse side of the Supplier invoice.

WARRANTY SERVICE INFORMATION



QUICK FITTING HOLDING COMPANY LLC.
30 PLAN WAY
WARWICK, RHODE ISLAND 02886
TEL: (877) 238-4826
FAX: (877) 258-4826

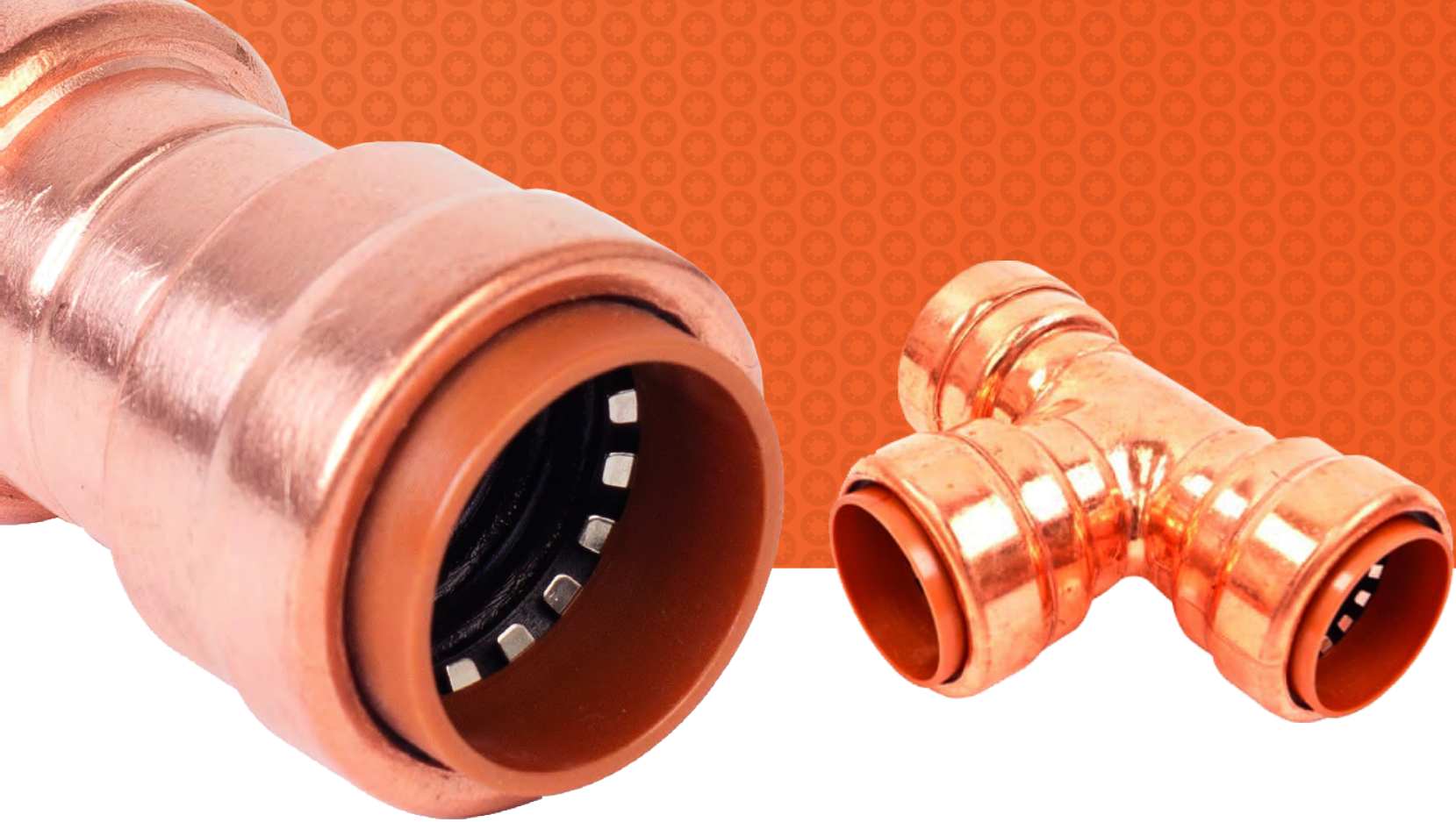

COPPERHEAD

BY **QUICKFITTING**

EASY • DURABLE • RELIABLE

QUICK FITTING HOLDING COMPANY, LLC.
655 WATERMAN AVE., EAST PROVIDENCE, RI, USA 02914
TEL: (877) 238-4826 / FAX: (877) 258-4826